



Level



Pressure



Flow



Temperature

Liquid
Analysis

Registration

Systems
Components

Services



Solutions

Technical Information

Proline Promass 83X

Coriolis Mass Flow Measuring System

Highly precise 4-tube technology for flow measurement of largest capacities in the oil and gas industry



Application

The Coriolis measuring principle operates independently of the physical fluid properties, such as viscosity and density.

- Extremely accurate measurement of liquids and gases such as oils, lubricants, fuels, liquefied gases, solvents, and compressed gases
- Mass flow measurement up to 4100 t/h (4520 tn. sh./h)
- Flanges: DN 300, 350, 400 (12", 14", 16")
- Fluid temperatures up to +180 °C (+356°F)
- Process pressures up to 100 bar (1440 psi)

Approvals for hazardous area:

- ATEX, FM, CSA, TIIS, IECEx, NEPSI

Connection to all common process control systems:

- HART, PROFIBUS DP/PA, FOUNDATION Fieldbus, MODBUS, EtherNet/IP

Relevant safety aspects:

- Maximum allowable pressure of secondary containment: 6 bar (87 psi) according to ASME BPVC, Pressure Equipment Directive, AD 2000, SIL-2
- Purge connections or rupture disk

Your benefits

The Promass measuring devices make it possible to simultaneously record several process variables (mass/density/temperature) for various process conditions during measuring operation.

The **Proline transmitter concept** comprises:

- Modular device and operating concept resulting in a higher degree of efficiency
- Software options for concentration measurement for extended range of application
- Diagnostic ability and data back-up for increased process quality

The **Promass sensors**, proven in use:

- Best performance due to PremiumCal
- Multivariable flow measurement in compact design
- Insensitivity to vibrations thanks to balanced four-tube measuring system
- Immune from external piping forces due to robust design
- Easy installation without taking inlet and outlet runs into consideration

Table of contents

Function and system design	3	Limiting flow	16
Measuring principle	3	Pressure loss	17
Measuring system	4		
Input	4	Mechanical construction	18
Measured variable	4	Design, dimensions	18
Measuring range	4	Weight	28
Operable flow range	5	Material	28
Input signal	5	Material load diagram	29
		Process connections	29
Output	5		
Output signal	5	Operability	30
Signal on alarm	7	Display elements	30
Load	7	Operating elements	30
Low flow cutoff	7	Language group	30
Galvanic isolation	7	Remote operation	30
Switching output	7		
		Certificates and approvals	30
Power supply	8	CE mark	30
Electrical connection Measuring unit	8	C-Tick symbol	30
Electrical connection, terminal assignment	9	Ex approval	30
Electrical connection Remote version	10	PROFIBUS DP/PA certification	30
Supply voltage	10	MODBUS certification	30
Cable entries	10	FOUNDATION Fieldbus certification	30
Remote version cable specification	10	Pressure equipment directive	31
Power consumption	10	Other standards and guidelines	31
Power supply failure	10	Functional safety	31
Potential equalization	10		
		Ordering Information	32
Performance characteristics	11		
Reference operating conditions	11	Accessories	32
Maximum measured error	11		
Repeatability	12	Documentation	32
Influence of medium temperature	12		
Influence of medium pressure	12	Registered trademarks	32
Design fundamentals	12		
Operating conditions: Installation	13		
Installation instructions	13		
Inlet and outlet runs	15		
Length of connecting cable	15		
System pressure	15		
Operating conditions: Environment	15		
Ambient temperature range	15		
Storage temperature	15		
Degree of protection	15		
Shock resistance	15		
Vibration resistance	15		
Electromagnetic compatibility (EMC)	15		
Operating conditions: Process	16		
Medium temperature range	16		
Fluid density range	16		
Medium pressure range (nominal pressure)	16		
Rupture disk	16		

Function and system design

Measuring principle

The measuring principle is based on the controlled generation of Coriolis forces. These forces are always present when both translational and rotational movements are superimposed.

$$F_C = 2 \cdot \Delta m (v \cdot \omega)$$

F_C = Coriolis force

Δm = moving mass

ω = rotational velocity

v = radial velocity in rotating or oscillating system

The amplitude of the Coriolis force depends on the moving mass Δm , its velocity v in the system, and thus on the mass flow. Instead of a constant angular velocity ω , the Promass sensor uses oscillation.

The measuring tubes through which the measured material flows are brought into oscillation. The Coriolis forces produced at the measuring tubes cause a phase shift in the tube oscillations (see illustration):

- At zero flow, in other words when the fluid is at a standstill, the two tubes oscillate in phase (1).
- Mass flow causes deceleration of the oscillation at the inlet of the tubes (2) and acceleration at the outlet (3).

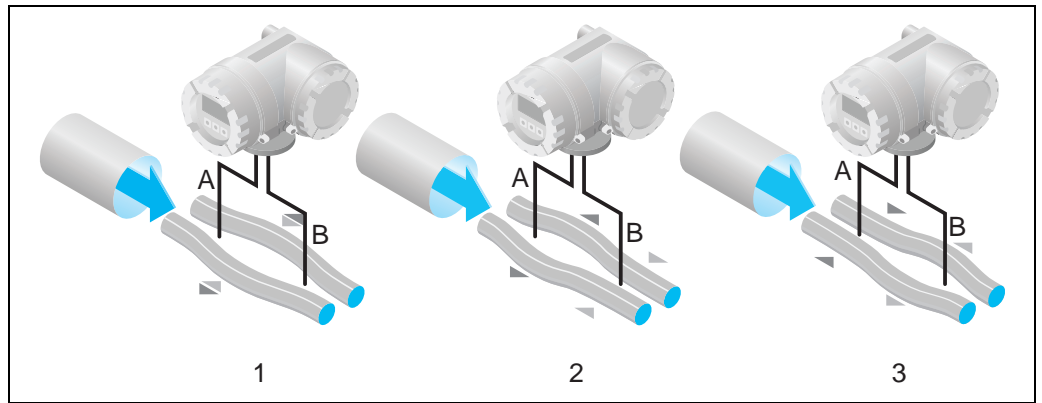

The phase difference (A-B) increases with increasing mass flow. Electrodynamic sensors register the tube oscillations at the inlet and outlet.

System balance is ensured by the antiphase oscillation of the two measuring tubes. The measuring principle operates independently of temperature, pressure, viscosity, conductivity and flow profile.

Density measurement

The measuring tubes are continuously excited at their resonance frequency. A change in the mass and thus the density of the oscillating system (comprising measuring tubes and fluid) results in a corresponding, automatic adjustment in the oscillation frequency. Resonance frequency is thus a function of fluid density. The microprocessor utilizes this relationship to obtain a density signal.

Temperature measurement

The temperature of the measuring tubes is determined in order to calculate the compensation factor due to temperature effects. This signal corresponds to the process temperature and is also available as an output.

Measuring system

The measuring system consists of a transmitter and a sensor. Two versions are available:

- Compact version: transmitter and sensor form a mechanical unit
- Remote version: transmitter and sensor are mounted physically separate from one another

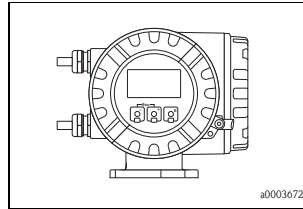
Transmitter Promass 83

- Four-line liquid-crystal display
- Operation with "Touch control"
- Application-specific Quick Setup
- Mass flow, volume flow, density and temperature measurement as well as calculated variables (e.g. fluid concentrations)

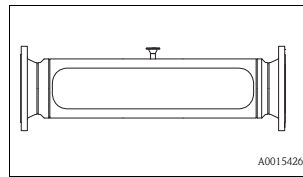
Sensor Promass X

- Universal sensor for fluid temperatures up to +180 °C (+356 °F).
- Nominal diameter DN 350 (14").
- Material: Stainless Steel EN 1.4404/ASTM 316L

Input**Measured variable**

- Mass flow (proportional to the phase difference between two sensors mounted on the measuring tube to register a phase shift in the oscillation)
- Fluid density (proportional to resonance frequency of the measuring tube)
- Fluid temperature (measured with temperature sensors)

Measuring range**Measuring ranges for liquids**

DN		Range for full scale values (liquids) $\dot{m}_{\min(F)}$ to $\dot{m}_{\max(F)}$	
350	14"	0 to 4100 t/h	0 to 4520 tn. sh./h

Measuring ranges for gases

The full scale values depend on the density of the gas. Use the formula below to calculate the full scale values:

$$\dot{m}_{\max(G)} = \dot{m}_{\max(F)} \cdot \rho_{(G)} \div x \text{ [kg/m}^3 \text{ (lb/ft}^3\text{)]}$$

$$\dot{m}_{\max(G)} = \text{max. full scale value for gas [kg/h (lb/min)]}$$

$$\dot{m}_{\max(F)} = \text{max. full scale value for liquid [kg/h (lb/min)]}$$

$$\rho_{(G)} = \text{gas density in [kg/m}^3 \text{ (lb/ft}^3\text{)] under process conditions}$$

$$x = \text{Coefficient for Promass X DN 350 (14"): } x = 200$$

Here, $\dot{m}_{\max(G)}$ can never be greater than $\dot{m}_{\max(F)}$

Calculation example for gas:

- Sensor type: Promass X, DN 350
- Gas: air with a density of 60.3 kg/m³ (at 20 °C and 50 bar)
- Measuring range (liquid): 70000 kg/h
- $x = 200$

Max. possible full scale value:

$$\dot{m}_{\max(G)} = \dot{m}_{\max(F)} \cdot \rho_{(G)} \div x \text{ [kg/m}^3 \text{]} = 70000 \text{ kg/h} \cdot 60.3 \text{ kg/m}^3 \div 200 \text{ kg/m}^3 = 21105 \text{ kg/h}$$

Recommended measuring ranges:

See information in the "Limiting flow" Section → 16

Operable flow range Greater than 1000 :1. Flow rates above the preset full scale value do not overload the amplifier, i.e. the totalizer values are registered correctly.

Input signal**Status input (auxiliary input)**

$U = 3$ to 30 V DC, $R_i = 5$ k Ω , galvanically isolated.

Configurable for: totalizer reset, positive zero return, error message reset, zero point adjustment start, batching start/stop (optional), totalizer reset for batching (optional).

Status input (auxiliary input) with PROFIBUS DP

$U = 3$ to 30 V DC, $R_i = 3$ k Ω , galvanically isolated.

Switch level: ± 3 to ± 30 V DC, independent of polarity.

Configurable for: positive zero return, error message reset, zero point adjustment start, batching start/stop (optional), totalizer reset for batching (optional).

Status input (auxiliary input) with MODBUS RS485

$U = 3$ to 30 V DC, $R_i = 3$ k Ω , galvanically isolated.

Switch level: ± 3 to ± 30 V DC, independent of polarity.

Configurable for: totalizer reset, positive zero return, error message reset, zero point adjustment start.

Current input

Active/passive selectable, galvanically isolated, resolution: 2 μ A

- Active: 4 to 20 mA, $R_L < 700$ Ω , $U_{out} = 24$ V DC, short-circuit proof
- Passive: $0/4$ to 20 mA, $R_i = 150$ Ω , $U_{max} = 30$ V DC

Output

Output signal**Current output**

Active/passive selectable, galvanically isolated, time constant selectable (0.05 to 100 s), full scale value selectable, temperature coefficient: typically 0.005% o.r./ $^{\circ}$ C, resolution: 0.5 μ A (o.r. = of reading)

- Active: $0/4$ to 20 mA, $R_L < 700$ Ω (for HART: $R_L \geq 250$ Ω)
- Passive: 4 to 20 mA; supply voltage U_S 18 to 30 V DC; $R_i \geq 150$ Ω

Pulse/frequency output

active/passive selectable, galvanically isolated

- Active: 24 V DC, 25 mA (max. 250 mA during 20 ms), $R_L > 100$ Ω
- Passive: open collector, 30 V DC, 250 mA
- Frequency output:
full scale frequency 2 to 10000 Hz ($f_{max} = 12500$ Hz), on/off ratio $1:1$, pulse width max. 2 s
- Pulse output:
pulse value and pulse polarity selectable, pulse width configurable (0.05 to 2000 ms)

PROFIBUS DP interface

- PROFIBUS DP in accordance with EN 50170 Volume 2
- Profile Version 3.0
- Data transmission rate: 9.6 kBaud to 12 MBaud
- Automatic data transmission rate recognition
- Signal encoding: NRZ Code
- Function blocks: $6 \times$ Analog Input, $3 \times$ Totalizer
- Output data: Mass flow, Volume flow, Corrected volume flow, Density, Reference density, Temperature, Totalizers 1 to 3
- Input data: Positive zero return (ON/OFF), Zero point adjustment, Measuring mode, Totalizer control
- Bus address can be configured via miniature switches or via the local display (optional)
- Available output combination \rightarrow  9

PROFIBUS PA interface

- PROFIBUS PA in accordance with EN 50170 Volume 2, IEC 61158-2 (MBP), galvanically isolated
- Data transmission rate: 31.25 kBit/s
- Current consumption: 11 mA
- Permitted supply voltage: 9 to 32 V
- Bus connection with integrated reverse polarity protection
- Error current FDE (Fault Disconnection Electronic): 0 mA
- Signal encoding: Manchester II
- Function blocks: 6 × Analog Input, 3 × Totalizer
- Output data: Mass flow, Volume flow, Corrected volume flow, Density, Reference density, Temperature, Totalizers 1 to 3
- Input data: Positive zero return (ON/OFF), Zero point adjustment, Measuring mode, Totalizer control
- Bus address can be configured via miniature switches or via the local display (optional)
- Available output combination →  9

MODBUS interface

- MODBUS device type: slave
- Address range: 1 to 247
- Supported function codes: 03, 04, 06, 08, 16, 23
- Broadcast: supported with the function codes 06, 16, 23
- Physical interface: RS485 in accordance with EIA/TIA-485 standard
- Supported baud rate: 1200, 2400, 4800, 9600, 19200, 38400, 57600, 115200 Baud
- Transmission mode: RTU or ASCII
- Response times:
 - Direct data access = typically 25 to 50 ms
 - Auto-scan buffer (data range) = typically 3 to 5 ms
- Possible output combinations →  9

FOUNDATION Fieldbus interface

- FOUNDATION Fieldbus H1, IEC 61158-2, galvanically isolated
- Data transmission rate: 31.25 kBit/s
- Current consumption: 12 mA
- Permitted supply voltage: 9 to 32 V
- Error current FDE (Fault Disconnection Electronic): 0 mA
- Bus connection with integrated reverse polarity protection
- Signal encoding: Manchester II
- ITK Version 5.01
- Function blocks:
 - 8 × Analog Input (Execution time: each 18 ms)
 - 1 × Digital Output (18 ms)
 - 1 × PID (25 ms)
 - 1 × Arithmetic (20 ms)
 - 1 × Input Selector (20 ms)
 - 1 × Signal Characterizer (20 ms)
 - 1 × Integrator (18 ms)
- Number of VCRs: 38
- Number of link objects in VFD: 40
- Output data: Mass flow, Volume flow, Corrected volume flow, Density, Reference density, Temperature, Totalizers 1 to 3
- Input data: Positive zero return (ON/OFF), Zero point adjustment, Measuring mode, Reset totalizer
- Link Master (LM) function is supported

Signal on alarm	Current output Failsafe mode selectable (e.g. in accordance with NAMUR Recommendation NE 43) Pulse/frequency output Failsafe mode selectable Relay output Dead in the event of a fault or if the power supply fails
Load	see "Output signal"
Low flow cutoff	Switch points for low flow are selectable.
Galvanic isolation	All circuits for inputs, outputs, and power supply are galvanically isolated from each other.
Switching output	Relay output <ul style="list-style-type: none">■ max. 30 V / 0.5 A AC; 60 V / 0.1 A DC■ galvanically isolated■ Normally closed (NC or break) or normally open (NO or make) contacts available (factory setting: relay 1 = NO, relay 2 = NC)

Power supply

Electrical connection
Measuring unit

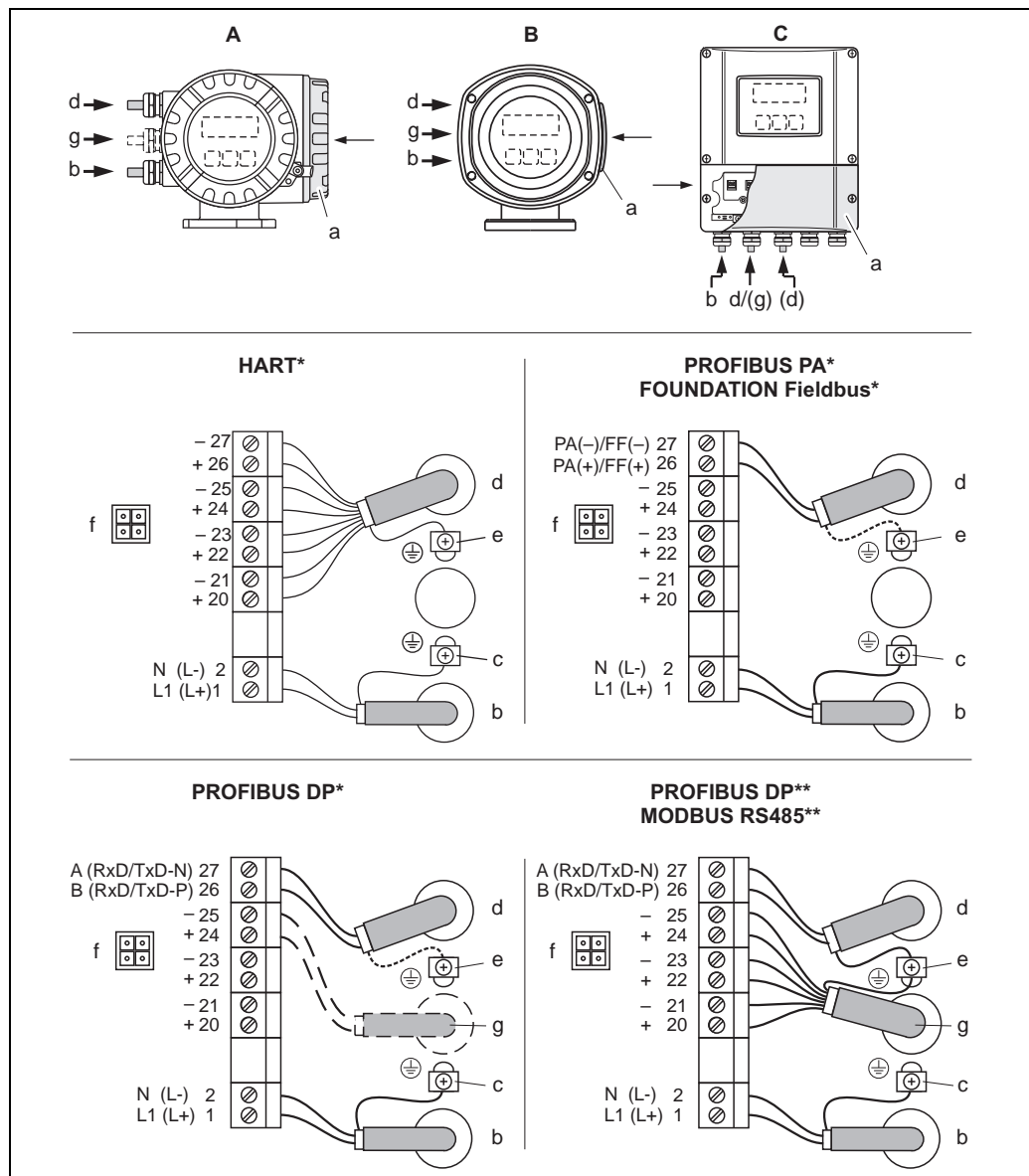

Connecting the transmitter, cable cross-section: max. 2.5 mm²

- A View A (field housing)
B View B (Stainless Steel field housing)
C View C (wall-mount housing)

*) fixed communication board

**) flexible communication board

a Connection compartment cover

b Cable for power supply: 85 to 260 V AC, 20 to 55 V AC, 16 to 62 V DC

Terminal No. 1: L1 for AC, L+ for DC

Terminal No. 2: N for AC, L- for DC

c Ground terminal for protective ground

d Signal cable: see Terminal assignment → 9

Fieldbus cable:

Terminal No. 26: DP (B) / PA (+) / FF (+) / MODBUS RS485 (B) / (PA, FF: with reverse polarity protection)

Terminal No. 27: DP (A) / PA (-) / FF (-) / MODBUS RS485 (A) / (PA, FF: with reverse polarity protection)

e Ground terminal for signal cable shield / fieldbus cable / RS485 line

f Service adapter for connecting service interface FXA 193 (Fieldcheck, FieldCare)

g Signal cable: see Terminal assignment → 9

g Cable for external termination (only for PROFIBUS DP with permanent assignment communication board):

Terminal No. 24: +5 V

Terminal No. 25: DGND

**Electrical connection,
terminal assignment**

The inputs and outputs on the communication board can be either permanently assigned (fixed) or variable (flexible), depending on the version ordered (see table). Replacements for modules which are defective or which have to be replaced can be ordered as accessories.

Order characteristic for "inputs/outputs"	Terminal No. (inputs/outputs)			
	20 (+) / 21 (-)	22 (+) / 23 (-)	24 (+) / 25 (-)	26 (+) / 27 (-)
<i>Fixed communication boards (permanent assignment)</i>				
A	-	-	Frequency output	Current output, HART
B	Relay output	Relay output	Frequency output	Current output, HART
F	-	-	-	PROFIBUS PA, Ex i
G	-	-	-	FOUNDATION Fieldbus Ex i
H	-	-	-	PROFIBUS PA
J	-	-	+5V (ext. termination)	PROFIBUS DP
K	-	-	-	FOUNDATION Fieldbus
Q	-	-	Status input	MODBUS RS485
R	-	-	Current output 2 Ex i, active	Current output 1 Ex i active, HART
S	-	-	Frequency output Ex i, passive	Current output Ex i Active, HART
T	-	-	Frequency output Ex i, passive	Current output Ex i Passive, HART
U	-	-	Current output 2 Ex i, passive	Current output 1 Ex i passive, HART
<i>Flexible communication boards</i>				
C	Relay output 2	Relay output 1	Frequency output	Current output, HART
D	Status input	Relay output	Frequency output	Current output, HART
E	Status input	Relay output	Current output 2	Current output, HART
L	Status input	Relay output 2	Relay output 1	Current output, HART
M	Status input	Frequency output 2	Frequency output 1	Current output, HART
N	Current output	Frequency output	Status input	MODBUS RS485
P	Current output	Frequency output	Status input	PROFIBUS DP
V	Relay output 2	Relay output 1	Status input	PROFIBUS DP
W	Relay output	Current output 3	Current output 2	Current output 1, HART
0	Status input	Current output 3	Current output 2	Current output 1, HART
2	Relay output	Current output 2	Frequency output	Current output 1, HART
3	Current input	Relay output	Current output 2	Current output 1, HART
4	Current input	Relay output	Frequency output	Current output, HART
5	Status input	Current input	Frequency output	Current output, HART
6	Status input	Current input	Current output 2	Current output 1, HART
7	Relay output 2	Relay output 1	Status input	MODBUS RS485

Electrical connection Remote version

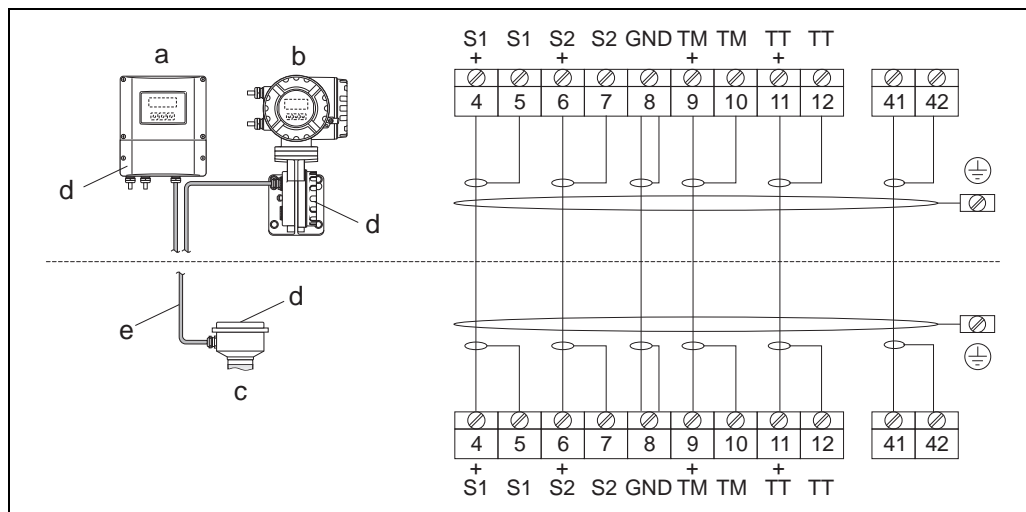

Connecting the remote version

- a Wall-mount housing: non-hazardous area and ATEX II3G / zone 2 → see separate "Ex documentation"
- b Wall-mount housing: ATEX II2G / Zone 1 / FM/CSA → see separate "Ex documentation"
- c Connection housing sensor
- d Cover for connection compartment or connection housing
- e Connecting cable

Terminal No.: 4/5 = gray; 6/7 = green; 8 = yellow; 9/10 = pink; 11/12 = white; 41/42 = brown

Supply voltage

85 to 260 V AC, 45 to 65 Hz
20 to 55 V AC, 45 to 65 Hz
16 to 62 V DC

Cable entries

Power-supply and signal cables (inputs/outputs):

- Cable entry M20 × 1.5 (8 to 12 mm / 0.31" to 0.47")
- Thread for cable entries, ½" NPT, G ½"

Connecting cable for remote version:

- Cable entry M20 × 1.5 (8 to 12 mm / 0.31" to 0.47")
- Thread for cable entries, ½" NPT, G ½"

Remote version cable specification

- 6 × 0.38 mm² (PVC cable with common shield and individually shielded cores)
- Conductor resistance: ≤ 50 Ω/km (≤ 0.015 Ω/ft)
- Capacitance: core/shield: ≤ 420 pF/m (≤ 128 pF/ft)
- Cable length: max. 20 m (65 ft)
- Permanent operating temperature: max. +105 °C (+221 °F)

Operation in zones of severe electrical interference:

The measuring device complies with the general safety requirements in accordance with EN 61010, the EMC requirements of EN 61326/A1, and NAMUR recommendation NE 21/43.

Power consumption

AC: <15 VA (including sensor)
DC: <15 W (including sensor)

Switch-on current:

- Max. 13.5 A (<50 ms) at 24 V DC
- Max. 3 A (<5 ms) at 260 V AC

Power supply failure

Lasting min. 1 power cycle:

- EEPROM and T-DAT save the measuring system data if the power supply fails.
- HistoROM/S-DAT: exchangeable data storage chip with sensor specific data (nominal diameter, serial number, calibration factor, zero point, etc.)

Potential equalization

No special measures for potential equalization are required. For instruments for use in hazardous areas, observe the corresponding guidelines in the specific Ex documentation.

Performance characteristics

o.r. = of reading; 1 g/cm³ = 1 kg/l; T = medium temperature

Reference operating conditions

- Error limits following ISO/DIN 11631
- Water, typically +15 to +45 °C (+59 to +113 °F); 2 to 6 bar (29 to 87 psi)
- Data according to calibration protocol ±5 °C (±9 °F) and ±2 bar (±29 psi)
- Accuracy based on accredited calibration rigs according to ISO 17025

Maximum measured error

The following values refer to the pulse/frequency output.
 The additional measured error at the current output is typically ±5 µA.
 Design fundamentals → [12](#).

- Mass flow and volume flow (liquids):
 - ±0.05% o.r. (PremiumCal, for mass flow)
 - ±0.10% o.r.
- Density (liquids)
 - Reference conditions: ±0.0005 g/cm³
 - Field density calibration: ±0.0005 g/cm³
(valid after a field density calibration under process conditions)
 - Standard density calibration: ±0.01 g/cm³
(valid over the entire measuring range and density range → [16](#))
 - Special density calibration: ±0.001 g/cm³
(optional, valid range: +5 to +80 °C (+41 to +176 °F) and 0.0 to 2.0 g/cm³)
- Temperature: ±0.5 °C ± 0.005 · T °C; (±1 °F ± 0.003 · (T - 32) °F)

Zero point stability

DN		Zero point stability	
[mm]	[inch]	[kg/h] or [l/h]	[lb/min]
350	14"	175	6.42

Example for max. measured error

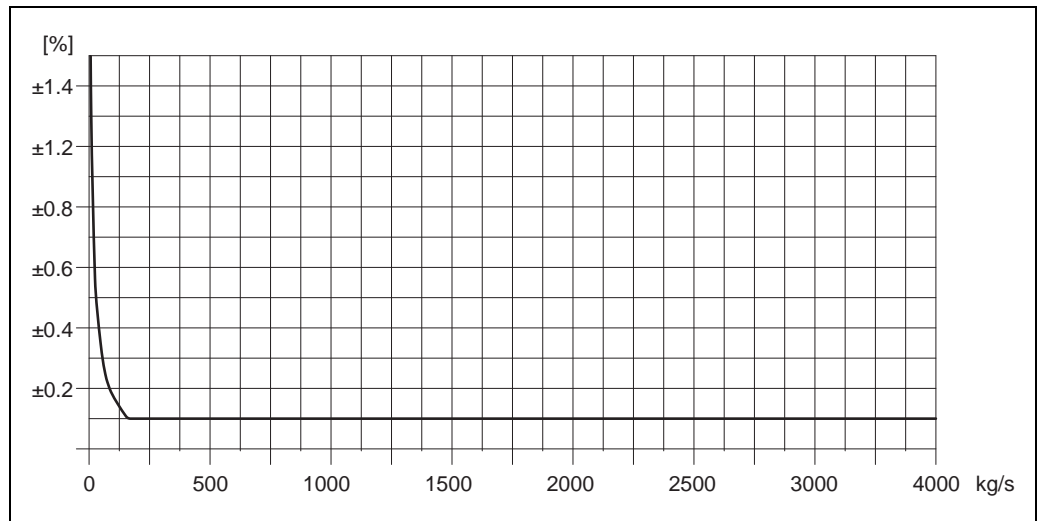

Max. measured error in % o.r. (example: Promass X, DN 350)

A0015046

Flow values (examples)

Design fundamentals → 12

Turn down	Flow		Max. measured error [% o.r.]
	[kg/h]	[lb/min]	
500 : 1	8200	1.323	2.1
100 : 1	41 000	6.615	0.4
25 : 1	164 000	26.46	0.1
10 : 1	410 000	66.15	0.1
2 : 1	2 050 000	330.75	0.1

Repeatability

Design fundamentals → 12.

- Mass flow and volume flow (liquids):
±0.025% o.r. (PremiumCal, for mass flow)
±0.05% o.r.
- Density (liquids): ±0.00025 g/cc
- Temperature: ±0.25 °C ± 0.0025 · T °C; (±0.5 °F ± 0.0015 · (T - 32) °F)

Influence of medium temperature

When there is a difference between the temperature for zero point adjustment and the process temperature, the typical measured error of the Promass sensor is ±0.0002% of the full scale value/°C (±0.0001% of the full scale value / °F).

Influence of medium pressure

The table below shows the effect on accuracy of mass flow due to a difference between calibration pressure and process pressure.

DN		[% o.r./bar]
[mm]	[inch]	
350	14"	-0.009

Design fundamentals

Dependent on the flow:

- Flow ≥ Zero point stability ÷ (base accuracy ÷ 100)
 - Max. measured error: ±base accuracy in % o.r.
 - Repeatability: ± ½ · base accuracy in % o.r.
- Flow < Zero point stability ÷ (base accuracy ÷ 100)
 - Max. measured error: ± (zero point stability ÷ measured value) · 100% o.r.
 - Repeatability: ± ½ · (zero point stability ÷ measured value) · 100% o.r.

Base accuracy	
Mass flow liquids, PremiumCal	0.05
Mass flow liquids	0.10
Volume flow liquids	0.10

Operating conditions: Installation

Installation instructions

Note the following points:

- No special measures such as supports are necessary. External forces are absorbed by the construction of the instrument, for example the secondary containment.
- The high oscillation frequency of the measuring tubes ensures that the correct operation of the measuring system is not influenced by pipe vibrations.
- No special precautions need to be taken for fittings which create turbulence (valves, elbows, T-pieces, etc.), as long as no cavitation occurs.
- For mechanical reasons and to protect the pipe, support is recommended for heavy sensors.

Mounting location

Entrained air or gas bubbles in the measuring tube can result in an increase in measuring errors.

Avoid the following mounting locations in the pipe:

- Highest point of a pipeline. Risk of air accumulating.
- Directly upstream from a free pipe outlet in a vertical pipeline

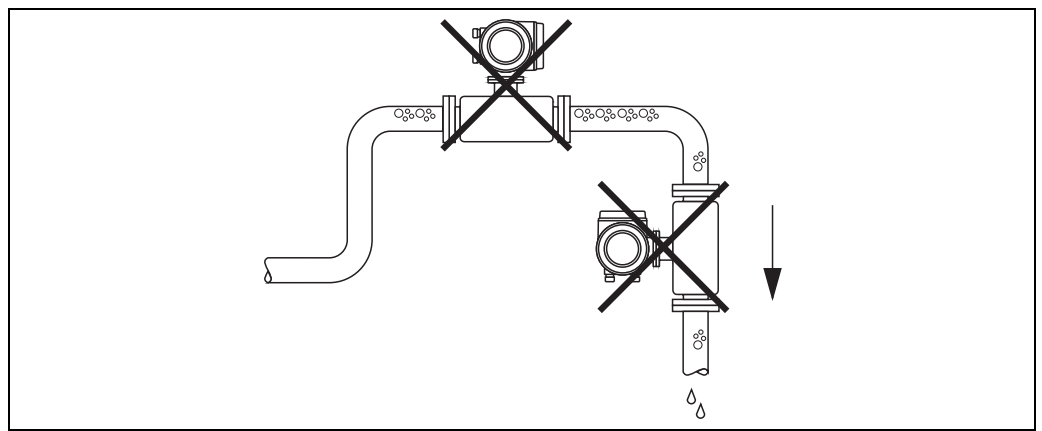

a0003605

Notwithstanding the above, the installation proposal below permits installation in an open vertical pipeline. Pipe restrictions or the use of an orifice with a smaller cross-section than the nominal diameter prevent the sensor running empty while measurement is in progress.

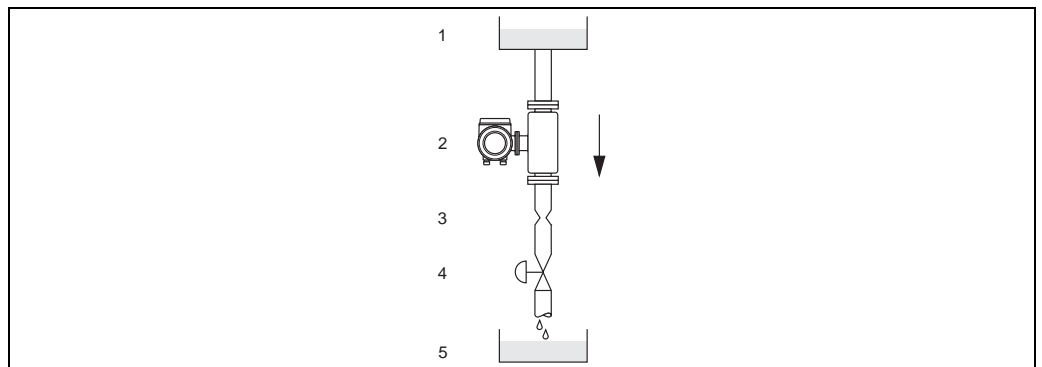

a0003597

Installation in a down pipe (e.g. for batching applications)

1 = Supply tank, 2 = Sensor, 3 = Orifice plate, pipe restriction (see table on following page), 4 = Valve, 5 = Batching tank

DN		Ø Orifice plate, pipe restriction	
[mm]	[inch]	mm	inch
350	14"	210	8.27

Orientation

Make sure that the direction of the arrow on the nameplate of the sensor matches the direction of flow (direction in which the fluid flows through the pipe).

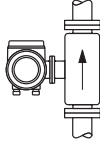
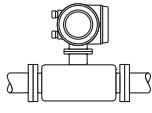
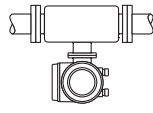
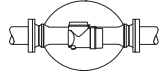
Orientation	Vertical	Horizontal, Transmitter head up	Horizontal, Transmitter head down	Horizontal, Transmitter head to the side
	 <i>Abb. V</i>	 <i>Abb. H1</i>	 <i>Abb. H2</i>	 <i>Abb. H3</i>
Compact version	✓✓	✓✓	✓✓	✓①
Remote version	✓✓	✓✓	✓✓	✓①

✓✓ = Recommended orientation; ✓ = Orientation recommended in certain situations; ✗ = Impermissible orientation

① When using a bent measuring tube and horizontal installation, the position of the sensor has to be matched to the fluid properties:

- Conditionally for fluids with entrained solids. Risk of solids accumulating!
- Conditionally for outgassing fluids. Risk of air accumulating!

Vertical (View V)

Recommended orientation with upward direction of flow (View V). When fluid is not flowing, entrained solids will sink down and gases will rise away from the measuring tube. The measuring tubes can be completely drained and protected against solids build-up.

Horizontal (Views H1, H2)

The measuring tubes must be horizontal and beside each other. When installation is correct the transmitter housing is above or below the pipe (Views H1, H2).

Heating

Some fluids require suitable measures to avoid loss of heat at the sensor. Heating can be electric, e.g. with heated elements, or by means of hot water or steam pipes made of copper or heating jackets.



Caution!

- Risk of electronics overheating! Make sure that the maximum permissible ambient temperature for the transmitter is not exceeded. Consequently, make sure that the adapter between sensor and transmitter and the connection housing of the remote version always remain free of insulating material. Note that a certain orientation might be required, depending on the fluid temperature → 14.
- When using electrical heat tracing whose heat is regulated using phase control or by pulse packs, it cannot be ruled out that the measured values are influenced by magnetic fields which may occur, (i.e. at values greater than those permitted by the EC standard (Sinus 30 A/m)). In such cases, the sensor must be magnetically shielded.

The secondary containment can be shielded with tin plates or electric sheets without privileged direction (e.g. V330-35A) with the following properties:

- Relative magnetic permeability $\mu_r \geq 300$
- Plate thickness $d \geq 0.35 \text{ mm}$ ($d \geq 0.01''$)

- Information on permissible temperature ranges → 15
- Especially under critical climatic conditions it has to be ensured that the temperature difference between environment and measured medium does not exceed 100K. Suitable measures, such as heating or thermal insulation, are to be taken.

Zero point adjustment

All devices are calibrated to state-of-the-art technology. The zero point determined in this way is imprinted on the nameplate of the device.

Calibration takes place under reference conditions. →  11

Promass therefore does **not** require zero point adjustment!

Experience shows that the zero point adjustment is advisable only in special cases:

- To achieve highest measuring accuracy also with very low flow rates
- Under extreme process or operating conditions (e.g. very high process temperatures or very high-viscosity fluids).

Inlet and outlet runs There are no installation requirements regarding inlet and outlet runs.

Length of connecting cable max. 20 m (65 ft), remote version

System pressure It is important to ensure that cavitation does not occur, because it would influence the oscillation of the measuring tube. No special measures need to be taken for fluids which have properties similar to water under normal conditions.

In the case of liquids with a low boiling point (hydrocarbons, solvents, liquefied gases) or in suction lines, it is important to ensure that pressure does not drop below the vapor pressure and that the liquid does not start to boil. It is also important to ensure that the gases that occur naturally in many liquids do not outgas. Such effects can be prevented when system pressure is sufficiently high.

For this reason, the following mounting locations are preferred:

- Downstream from pumps (no risk of partial vacuum)
- At the lowest point in a vertical pipe

Operating conditions: Environment

Ambient temperature range Sensor and transmitter

- Standard: -20 to +60 °C (-4 to +140 °F)
- Optional: -40 to +60 °C (-40 to +140 °F)

 Note!

- Install the device at a shady location. Avoid direct sunlight, particularly in warm climatic regions.
- At ambient temperatures below -20 °C (-4 °F) the readability of the display may be impaired.

Storage temperature -40 to +80 °C (-40 to +175 °F), preferably +20 °C (+68 °F)

Degree of protection Standard: IP 67 (NEMA 4X) for transmitter and sensor

Shock resistance In accordance with IEC 60068-2-31

Vibration resistance Acceleration up to 1 g, 10 to 150 Hz, following IEC 60068-2-6

Electromagnetic compatibility (EMC) To IEC/EN 61326 and NAMUR Recommendation NE 21

Operating conditions: Process

Medium temperature range	Sensor –50 to +180 °C (–58 to +356 °F)
Fluid density range	0 to 5000 kg/m ³ (0 to 312 lb/cf)
Medium pressure range (nominal pressure)	Flanges <ul style="list-style-type: none"> ■ according to DIN PN 10 to 100 ■ according to ASME B16.5 Cl 150, Cl 300, Cl 600 Pressure ranges of secondary containment Type approved, maximum allowable pressure according to ASME BPVC: 6 bar (87 psi) The secondary containment is equipped with special pressure monitoring connections. With the help of these connections, fluid collected in the secondary containment in the event of tube failure can be bled off. This is especially important in high pressure applications. These connections can also be used for gas circulation and/or gas detection (dimensions → 18).
Rupture disk	Further information → 26
Limiting flow	See information in the "Measuring range" Section → 4 Select nominal diameter by optimizing between required flow range and permissible pressure loss. An overview of max. possible full scale values can be found in the "Measuring range" Section. <ul style="list-style-type: none"> ■ The minimum recommended full scale value is approx. 1/20 of the max. full scale value. ■ In most applications, 20 to 50% of the maximum full scale value can be considered ideal. ■ Select a lower full scale value for abrasive substances such as fluids with entrained solids (flow velocity <1 m/s (<3 ft/s)). ■ For gas measurement the following rules apply: <ul style="list-style-type: none"> – Flow velocity in the measuring tubes should not be more than half the sonic velocity (0.5 Mach). – The maximum mass flow depends on the density of the gas: formula → 4

Pressure loss

Pressure loss depends on the fluid properties and on the flow rate. The following formulae can be used to approximately calculate the pressure loss:

Reynolds number	$Re = \frac{4 \cdot \dot{m}}{\pi \cdot d \cdot v \cdot \rho \cdot n}$
Pressure loss	$\Delta p = (A_0 + A_1 \cdot Re^{A_2})^{1/A_3} \cdot \frac{1}{\rho} \cdot \left(\frac{2 \cdot \dot{m}}{5 \cdot \pi \cdot n \cdot d^2} \right)^2$
<p>Δp = pressure loss [mbar] v = kinematic viscosity [m²/s] \dot{m} = Mass flow [kg/s] ρ = fluid density [kg/m³]</p> <p>d = inside diameter of measuring tubes [m] A_0 to A_3 = constants (depending on nominal diameter) n = number of tubes</p>	

Pressure loss coefficient

DN		d[mm]	A ₀	A ₁	A ₂	A ₃
[mm]	[inch]					
350	14"	102.3	0.76	3.80	-0.33	0.23

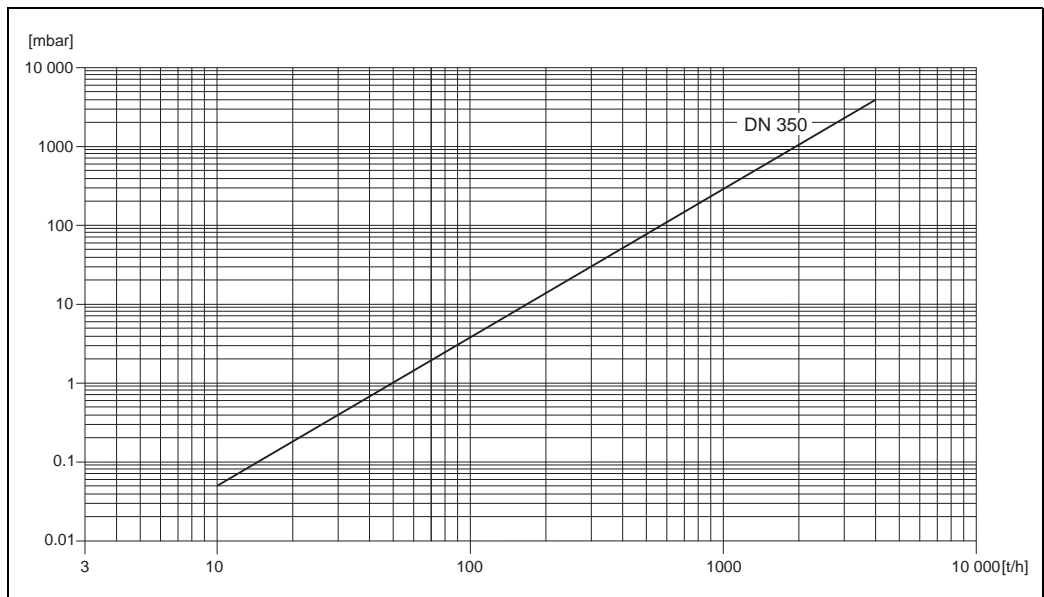

Pressure loss diagram for water

Pressure loss (US units)

Pressure loss is dependent on fluid properties nominal diameter.

Mechanical construction

Design, dimensions

Dimensions	
Field housing compact version, powder-coated die-cast aluminum and stainless steel	→ 19
Sensor remote version, connection housing (II2G/Zone 1)	→ 20
Transmitter remote version, wall-mount housing (non Ex-zone and II3G/Zone 2)	→ 21
Sensor remote version, connection housing	→ 22
Process connections in SI units	
Flange connections EN (DIN)	→ 23
Flange connections ASME B16.5	→ 24
Process connections in US units	
Flange connections ASME B16.5	→ 25
Purge connections / secondary containment monitoring	→ 26
Rupture disk	→ 27

Field housing compact version, powder-coated die-cast aluminum and stainless steel

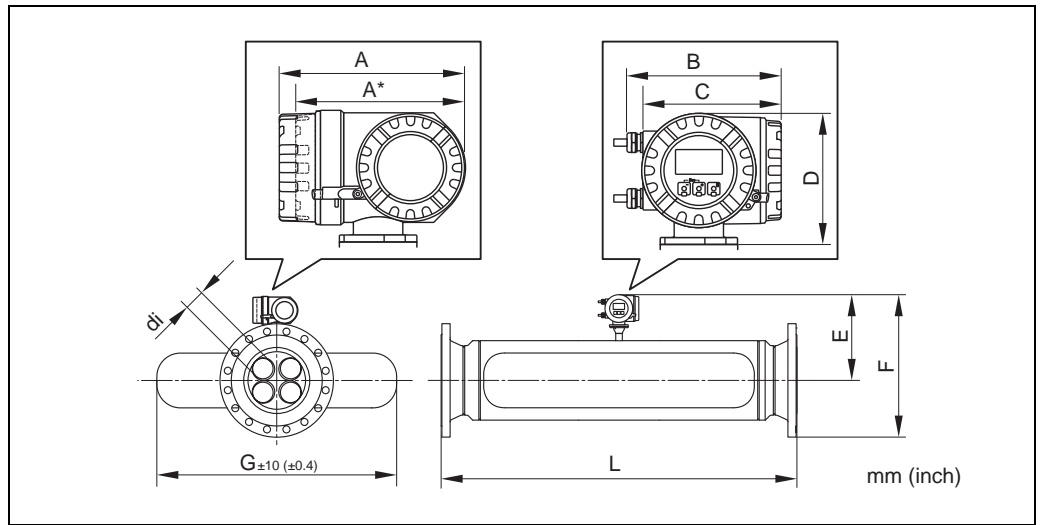

A0015429

Dimensions in SI units and US units for powder-coated die-cast aluminum

DN	A	A*	B	C	D	E	F	G	L	di
350	227	207	187	168	160	445	¹⁾	1230	¹⁾	102.26

All dimensions in [mm]

* Blind version (without display)

¹⁾ dependent on respective process connection

DN	A	A*	B	C	D	E	F	G	L	di
14"	8.94	8.15	7.68	6.61	6.30	17.52	¹⁾	1230	¹⁾	4.03

All dimensions in [inch]

* Blind version (without display)

¹⁾ dependent on respective process connection

Dimensions in SI units and US units for stainless steel (II2G/Zone 1)

DN	A	A*	B	C	D	E	F	G	L	di
350	240	217	206	186	178	448	¹⁾	1248	¹⁾	102.26

All dimensions in [mm]

* Blind version (without display)

¹⁾ dependent on respective process connection

DN	A	A*	B	C	D	E	F	G	L	di
14"	9.45	8.54	8.11	7.32	7.01	17.64	¹⁾	49.1	¹⁾	4.03

All dimensions in [inch]

* Blind version (without display)

¹⁾ dependent on respective process connection



Note!

Dimensions for remote version II2G/Zone 1 → 20

Sensor remote version, connection housing (II2G/Zone 1)

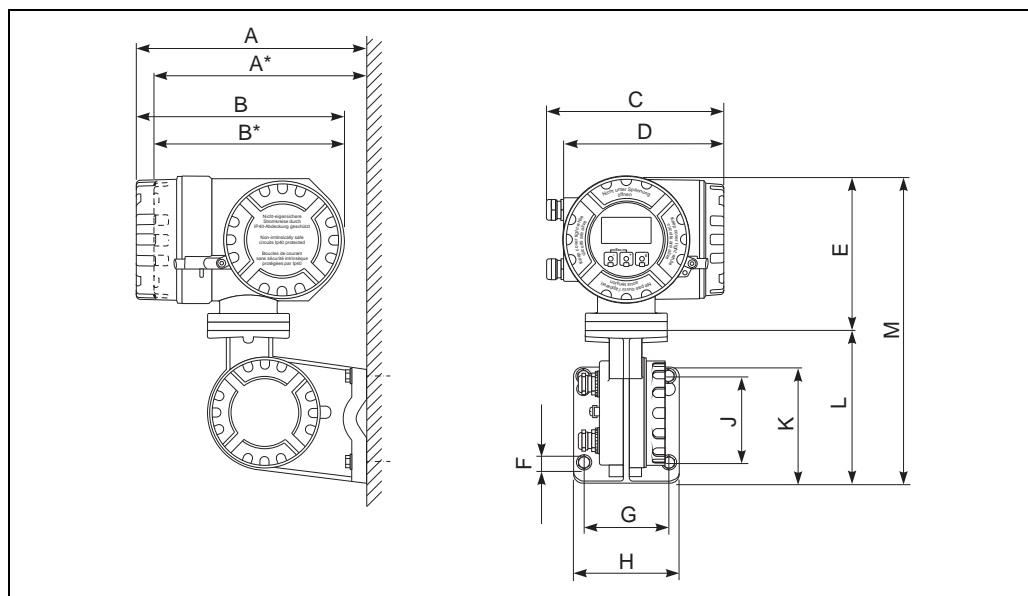

a0002128

Dimensions in SI units

A	A*	B	B*	C	D	E	F Ø	G	H	J	K	L	M
265	242	240	217	206	186	178	8.6(M8)	100	130	100	144	170	348

* Blind version (without display)

All dimensions in [mm]

Dimensions in US units

A	A*	B	B*	C	D	E	F Ø	G	H	J	K	L	M
10.4	9.53	9.45	8.54	8.11	7.32	7.01	0,34 (M8)	3.94	5.12	3.94	5.67	6.69	13.7

* Blind version (without display)

All dimensions in [inch]

Transmitter remote version, wall-mount housing (non Ex-zone and II3G/Zone 2)

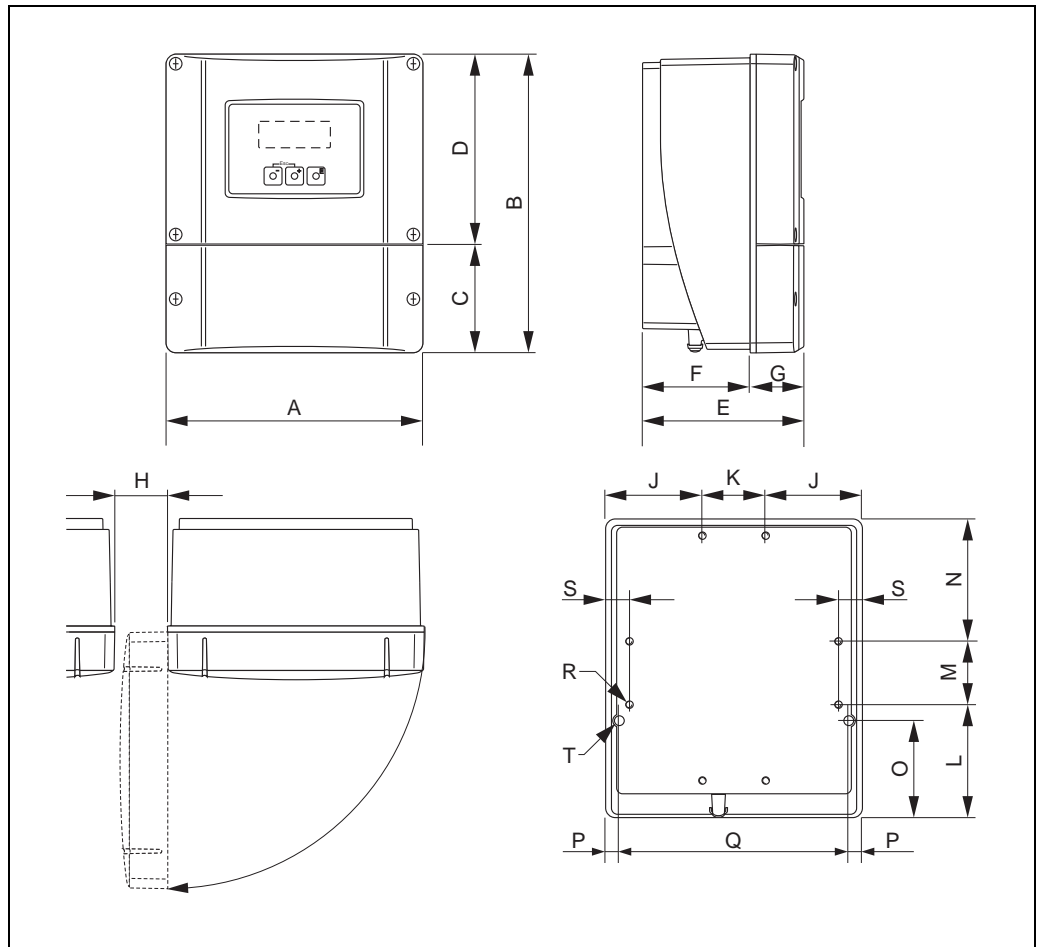

a0001150

Dimensions in SI units

A	B	C	D	E	F	G	H	J	K
215	250	90.5	159.5	135	90	45	>50	81	53
L	M	N	O	P	Q	R	S	T ¹⁾	
95	53	102	81.5	11.5	192	8 × M5	20	2 × ∅ 6.5	

¹⁾ Fixing bolt for wall assembly: M6 (screw head max. 10.5 mm)
All dimensions in [mm]

Dimensions in US units

A	B	C	D	E	F	G	H	J	K
8.46	9.84	3.56	6.27	5.31	3.54	1.77	>1.97	3.18	2.08
L	M	N	O	P	Q	R	S	T ¹⁾	
3.74	2.08	4.01	3.20	0.45	7.55	8 × M5	0.79	2 × ∅ 0.26	

¹⁾ Fixing bolt for wall assembly: M6 (screw head max. 0.41 inch)
All dimensions in [inch]

Sensor remote version, connection housing

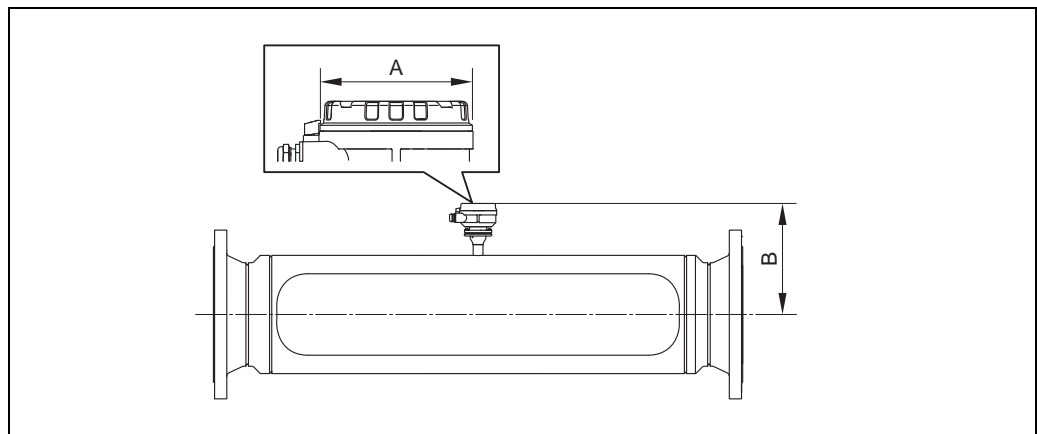

A0015436

Dimensions in SI units

DN	A	B
350	129	389

All dimensions in [mm]

¹⁾ dependent on respective process connection*Dimensions in US units*

DN	A	B
14"	5.08	15.31

All dimensions in [inch]

¹⁾ dependent on respective process connection

Process connections in SI units

Flange connections EN (DIN), ASME B16.5

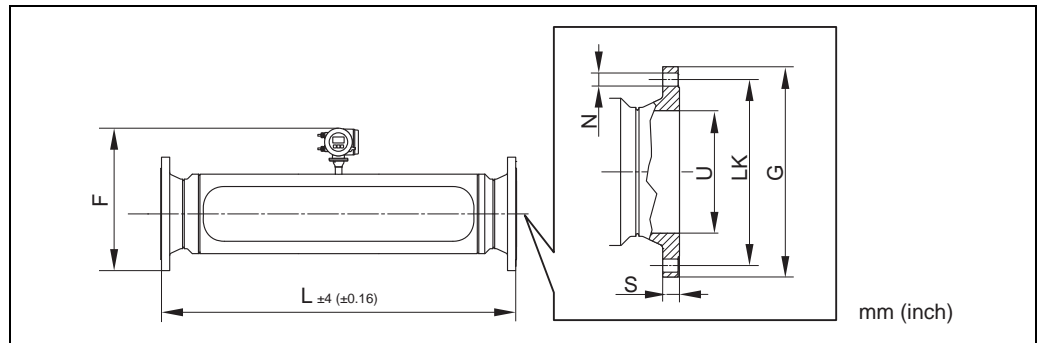

A0015431

Flange connections EN (DIN)

Flange according to EN 1092-1 (DIN 2501 / DIN 2512N) / PN 10: 1.4404/316/316L							
Surface roughness (flange): EN 1092-1 Form B1 (DIN 2526 Form C), Ra 3.2 to 12.5 µm							
DN	F	L	G	N	S	LK	U
300	665.8	1714	445	12 x Ø22	26	400	309.7
350	695.8	1714	505	16 x Ø22	26	460	341.4
400	725.8	1723	565	16 x Ø26	26	515	392.2

All dimensions in [mm]

Flange according to EN 1092-1 (DIN 2501 / DIN 2512N) / PN 16: 1.4404/316/316L							
Surface roughness (flange): EN 1092-1 Form B1 (DIN 2526 Form C), Ra 3.2 to 12.5 µm							
DN	F	L	G	N	S	LK	U
300	673.3	1734	460	12 x Ø26	28	410	309.7
350	703.3	1742	520	16 x Ø26	30	470	339.6
400	733.3	1749	580	16 x Ø30	32	525	390.4

All dimensions in [mm]

Flange according to EN 1092-1 (DIN 2501 / DIN 2512N) / PN 40: 1.4404/316/316L							
Surface roughness (flange): EN 1092-1 Form B1 (DIN 2526 Form C), Ra 3.2 to 12.5 µm							
DN	F	L	G	N	S	LK	U
300	700.8	1808	515	16 x Ø33	42	450	307.9
350	733.3	1828	580	16 x Ø36	46	510	338.0
400	733.3	1846	660	16 x Ø39	50	585	384.4

All dimensions in [mm]

Flange according to EN 1092-1 (DIN 2501 / DIN 2512N) / PN 63: 1.4404/316/316L							
Surface roughness (flange): EN 1092-1 Form B1 (DIN 2526 Form C), Ra 3.2 to 12.5 µm							
DN	F	L	G	N	S	LK	U
300	708.3	1854	530	16 x Ø36	52	460	301.9
350	743.3	1874	600	16 x Ø39	56	525	330.6
400	778.3	1892	670	16 x Ø42	60	585	378.0

All dimensions in [mm]

Flange according to EN 1092-1 (DIN 2501 / DIN 2512N) / PN 100: 1.4404/316/316L							
Surface roughness (flange): EN 1092-1 Form B1 (DIN 2526 Form C), Ra 3.2 to 12.5 µm							
DN	F	L	G	N	S	LK	U
300	735.8	1912	585	16 x Ø42	68	500	295.5
350	770.8	1948	655	16 x Ø48	74	560	323.6
400	800.8	1950	715	16 x Ø48	82.2	620	364.9

All dimensions in [mm]

Flange connections ASME B16.5

Flange according to ASME B16.5 / Cl 150: 1.4404/316/316L								
Surface roughness (flange): Ra 3.2 to 6.3 µm								
DN	F	L	G	N	S	LK	U	
300	12"	684.6	1802	482.6	12 x Ø25.4	32.2	431.8	304.8
350	14"	710.0	1828	533.4	16 x Ø28.4	35.5	476.3	336.5
400	16"	741.8	1828	596.9	16 x Ø28.4	37.0	539.8	387.3

All dimensions in [mm]

Flange according to ASME B16.5 / Cl 300: 1.4404/316/316L								
Surface roughness (flange): Ra 3.2 to 6.3 µm								
DN	F	L	G	N	S	LK	U	
300	12"	703.7	1834	520.7	16 x Ø31.8	51.3	450.9	304.8
350	14"	735.4	1860	584.2	16 x Ø31.8	54.4	514.4	336.5
400	16"	767.2	1866	647.7	16 x Ø35.1	57.6	571.5	387.3

All dimensions in [mm]

Flange according to ASME B16.5 / Cl 600: 1.4404/316/316L								
Surface roughness (flange): Ra 3.2 to 6.3 µm								
DN	F	L	G	N	S	LK	U	
300	12"	722.7	1886	558.8	20 x Ø35.1	73.7	489.0	288.8
350	14"	745.0	1904	603.3	20 x Ø38.1	77.0	527.1	317.5
400	16"	786.2	1926	685.8	20 x Ø41.1	83.2	603.3	363.3

All dimensions in [mm]

Process connections in US units

Flange connections ASME B16.5

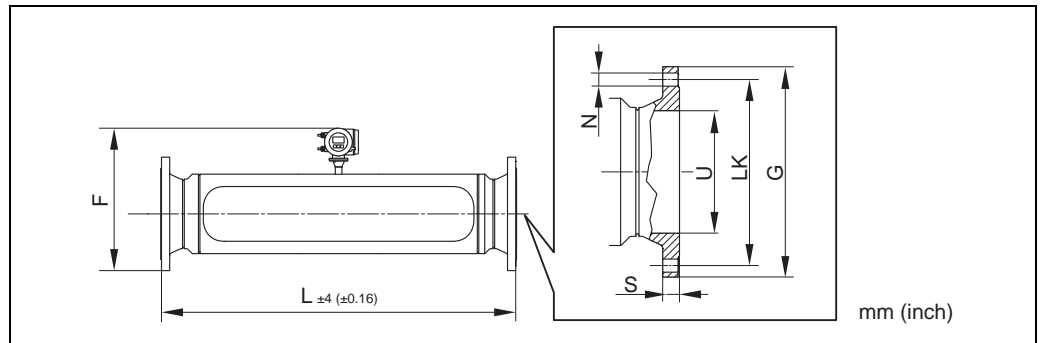

A0015431

Flange according to ASME B16.5 / Cl 150: 1.4404/316/316L							
Surface roughness (flange): Ra 3.2 to 6.3 µm							
DN	F	L	G	N	S	LK	U
12"	26.95	70.94	19.00	12 x Ø1.00	1.27	17.00	12.00
14"	27.95	71.97	21.00	16 x Ø1.12	1.40	18.75	13.25
16"	29.20	71.97	23.50	16 x Ø1.12	1.46	21.25	15.25

All dimensions in [inch]

Flange according to ASME B16.5 / Cl 300: 1.4404/316/316L							
Surface roughness (flange): Ra 3.2 to 6.3 µm							
DN	F	L	G	N	S	LK	U
12"	27.70	72.20	20.50	16 x Ø1.25	2.02	17.75	12.00
14"	28.95	73.23	23.00	16 x Ø1.25	2.14	20.25	13.25
16"	30.20	73.46	25.50	16 x Ø1.38	2.27	22.50	15.25

All dimensions in [inch]

Flange according to ASME B16.5 / Cl 600: 1.4404/316/316L							
Surface roughness (flange): Ra 3.2 to 6.3 µm							
DN	F	L	G	N	S	LK	U
12"	28.45	74.25	22.00	20 x Ø1.38	2.90	19.25	11.37
14"	29.33	74.96	23.75	20 x Ø1.50	3.03	20.75	12.50
16"	30.95	75.83	27.00	20 x Ø1.62	3.28	23.75	14.30

All dimensions in [inch]

Purge connections / secondary containment monitoring**Caution!**

The secondary containment is filled with dry nitrogen (N_2). Do not open the purge connections unless the containment can be filled immediately with a dry inert gas. Use only low gauge pressure to purge.
Maximum pressure: 5 bar (72.5 psi).

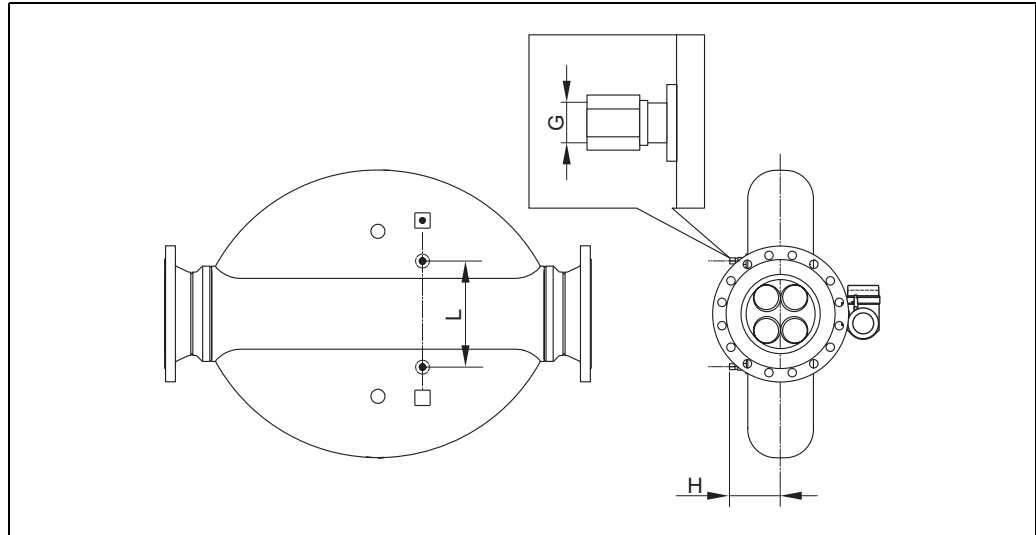

A0015430

DN		G	H		L	
[mm]	[inch]		[mm]	[inch]	[mm]	[inch]
350	14"	1/2" NPT	182	7.17	547	21.53

Rupture disk

Sensor housings with integrated rupture disks are optionally available.



Warning!

- Make sure that the function and operation of the rupture disk is not impeded through the installation. Triggering overpressure in the housing as stated on the indication label. Take adequate precautions to ensure that no damage occurs, and risk to human life is ruled out, if the rupture disk is triggered. Rupture disk: Burst pressure 5.5 to 6.5 bar (80 to 94 psi).
- Please note that the housing can no longer assume a secondary containment function if a rupture disk is used.
- It is not permitted to open the connections or remove the rupture disk.



Caution!

The existing connection nozzles are not designed for a rinse or pressure monitoring function.



Note!

- Before commissioning, please remove the transport protection of the rupture disk.
- Please note the indication labels.

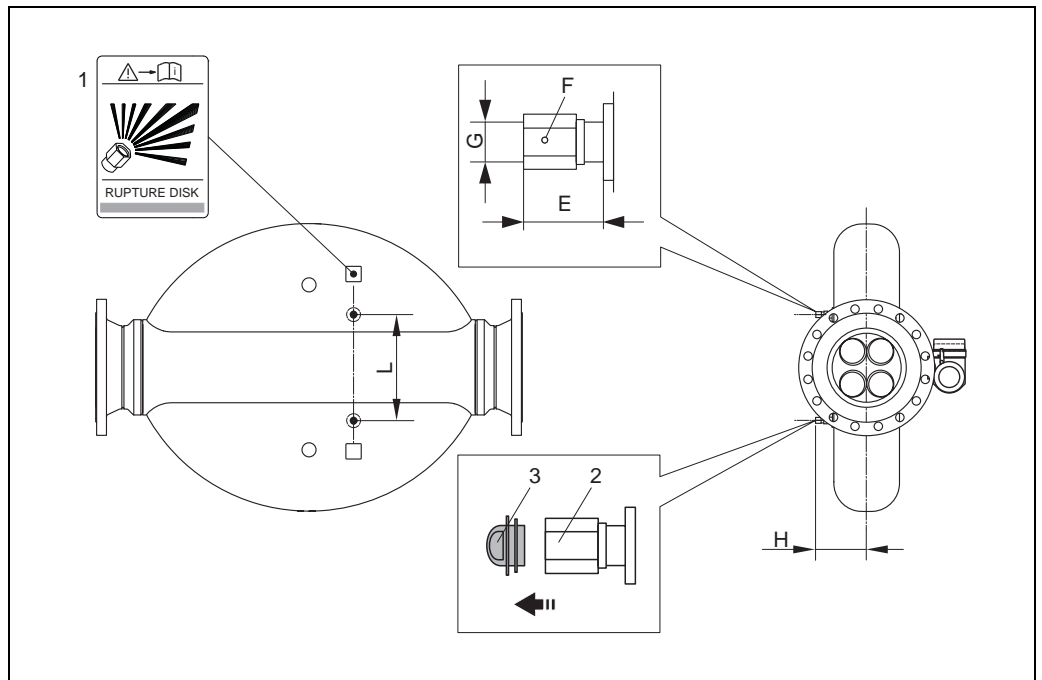

- 1 Indication label for the rupture disk
- 2 1/2" NPT internal screw thread with 1" width across flat
- 3 Transport protection

DN		E		F	G	H		L	
[mm]	[inch]	[mm]	[inch]			[mm]	[inch]	[mm]	[inch]
350	14"	approx. 42	approx. 1.65	SW 1"	1/2" NPT	approx. 220	approx. 8.66	547	21.53

Weight

- Compact version: see tables below
- Remote version
 - Transmitter: see the tables below
 - Wall-mount housing: 5 kg (11 lbs)

	[kg]	[lbs]
Compact version	555	1224
Compact version Ex d	564	1244
Remote version	553	1219

¹⁾ with 12" Cl 150 flanges according to ASME B16.5

Material**Transmitter housing**

Compact version

- Stainless steel housing: stainless steel 1.4404/CF3M
- Powder coated die-cast aluminum
- Window material: Glass

Remote version

- Remote field housing: powder coated die-cast aluminum
- Wall-mount housing: powder coated die-cast aluminum
- Window material: Glass

Sensor housing / containment

- Acid and alkali-resistant outer surface
- Stainless Steel 1.4404/316L

Connection housing, sensor (remote version)

- Powder coated die-cast aluminum

Process connections

1.4404/316/316L

Measuring tubes

Stainless Steel 1.4404/316/316L

Material load diagram



Warning!

The following material load curves refer to the entire sensor and not just the process connection.

Flange connection according to EN 1092-1 (DIN 2501)

Flange material: 1.4404/316/316L

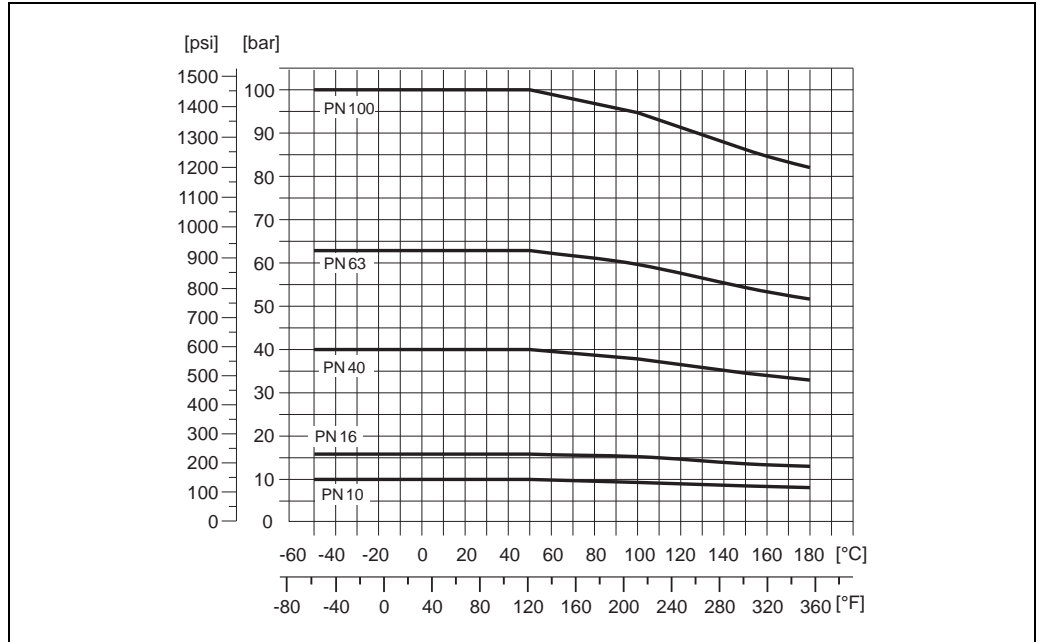

A0015432

Flange connection according to ASME B16.5

Flange material: 1.4404/316/316L

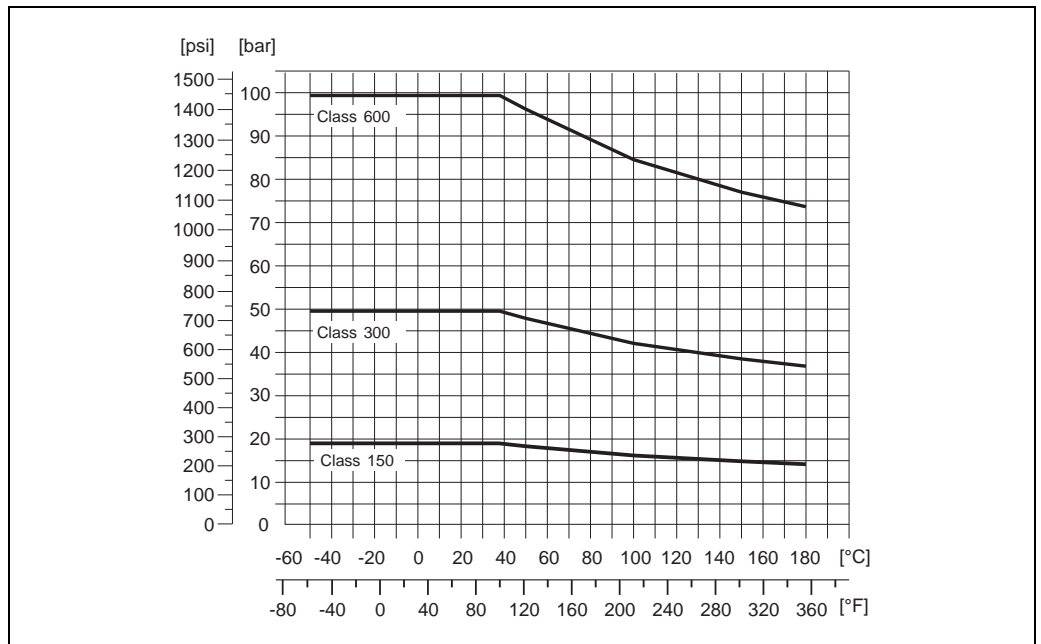

A0015434

Process connections

- Flanges according to EN 1092-1 (DIN 2501)
- Flanges according to ASME B16.5

Operability

Display elements	<ul style="list-style-type: none"> ■ Liquid-crystal display: backlit and four lines with 16 characters per line ■ Selectable display of different measured values and status variables ■ At ambient temperatures below -20 °C (-4 °F) the readability of the display may be impaired.
Operating elements	<ul style="list-style-type: none"> ■ Local operation with three optical keys (□/□/□) ■ Application-specific Quick Setup menus for straightforward commissioning
Language group	<p>Language groups available for operation in different countries:</p> <ul style="list-style-type: none"> ■ Western Europe and America (WEA): English, German, Spanish, Italian, French, Dutch and Portuguese ■ Eastern Europe/Scandinavia (EES): English, Russian, Polish, Norwegian, Finnish, Swedish and Czech ■ South and Eastern Asia (SEA): English, Japanese, Indonesian ■ China (CN): English, Chinese <p>The language group is changed using the "FieldCare" operating program.</p>
Remote operation	Remote operation via HART, PROFIBUS DP/PA, FOUNDATION Fieldbus, MODBUS RS485

Certificates and approvals

CE mark	The measuring system is in conformity with the statutory requirements of the EC Directives. Endress+Hauser confirms successful testing of the device by affixing to it the CE mark.
C-Tick symbol	The measuring system complies with the EMC requirements of the "Australian Communications and Media Authority (ACMA)"
Ex approval	Information about currently available Ex versions (ATEX, FM, CSA, IECEx, NEPSI) can be supplied by your Endress+Hauser Sales Center on request. All explosion protection data are contained in separate explosion protection documentation which you can order if required.
PROFIBUS DP/PA certification	<p>The flow device has successfully passed all the test procedures carried out and is certified and registered by the PNO (PROFIBUS User Organization). The device thus meets all the requirements of the following specifications:</p> <ul style="list-style-type: none"> ■ Certified to PROFIBUS Profile Version 3.0 (device certification number: on request) ■ The device can also be operated with certified devices of other manufacturers (interoperability)
MODBUS certification	The measuring device meets all the requirements of the MODBUS/TCP conformity and integration test and has the "MODBUS/TCP Conformance Test Policy, Version 2.0". The measuring device has successfully passed all the test procedures carried out and is certified by the "MODBUS/TCP Conformance Test Laboratory" of the University of Michigan.
FOUNDATION Fieldbus certification	<p>The flowmeter has passed all the test procedures implemented and has been certified and registered by the Fieldbus Foundation. The flowmeter thus meets all the requirements of the specifications listed below:</p> <ul style="list-style-type: none"> ■ Certified to FOUNDATION Fieldbus specification ■ The flowmeter meets all the specifications of the FOUNDATION Fieldbus-H1. ■ Interoperability Test Kit (ITK), revision status 5.01 (Certification on request) ■ The device can also be operated in conjunction with other-make certified devices. ■ Physical Layer Conformance Test of the Fieldbus Foundation

Pressure equipment directive The measuring devices can be ordered with or without PED (Pressure Equipment Directive). If a device with PED is required, this must be ordered explicitly.

- With the identification PED/G1/III on the sensor nameplate, Endress+Hauser confirms conformity with the "Basic safety requirements" of Appendix I of the Pressure Equipment Directive 97/23/EC.
- Devices with this identification (with PED) are suitable for the following types of fluid:
 - Fluids of Group 1 and 2 with a steam pressure of greater than, or smaller and equal to 0.5 bar (7.3 psi)
 - Unstable gases
- Devices without this identification (without PED) are designed and manufactured according to good engineering practice. They correspond to the requirements of Art. 3, Section 3 of the Pressure Equipment Directive 97/23/EC. Their application is illustrated in Diagrams 6 to 9 in Appendix II of the Pressure Equipment Directive 97/23/EC.

Optionally flowmeters in accordance to the guidelines AD 2000 are available on request.

Other standards and guidelines

- EN 60529
Degrees of protection by housing (IP code)
- EN 61010-1
Protection Measures for Electrical Equipment for Measurement, Control, Regulation and Laboratory Procedures.
- IEC/EN 61326
"Emission in accordance with Class A requirements".
Electromagnetic compatibility (EMC requirements).
- NAMUR NE 21
Electromagnetic compatibility (EMC) of industrial process and laboratory control equipment.
- NAMUR NE 43
Standardization of the signal level for the breakdown information of digital transmitters with analog output signal.
- NAMUR NE 53
Software of field devices and signal-processing devices with digital electronics

Functional safety SIL -2: accordance IEC 61508/IEC 61511-1 (FDIS)

"4–20 mA" - output according to the following options in the order characteristic for "Input/Output":
A, B, C, D, E, L, M, R, S, T, U, W, 0, 2, 3, 4, 5, 6
See also "Electrical connection, terminal assignment" →  9

Ordering Information

The Endress +Hauser service organization can provide detailed ordering information and information on the order codes upon request.

Accessories

Various accessories, which can be ordered separately from Endress+Hauser, are available for the transmitter and the sensor.

Documentation

- Flow measuring technology (FA00005D)
- Operating Instructions/Description of Device Functions
 - Promass 83 HART (BA00059D/BA00060D)
 - Promass 83 FOUNDATION Fieldbus (BA00065D/BA00066D)
 - Promass 83 PROFIBUS DP/PA(BA00063D/BA00064D)
 - Promass 83 MODBUS (BA00107D/BA00108D)
- Supplementary documentation on Ex-ratings: ATEX, FM, CSA, IECEx, NEPSI
- Special Documentation
 - Functional safety manual Promass 80, 83 (SD00077D)
 - Data transmission via EtherNet/IP (SD00138D)

Registered trademarks

HART®

Registered trademark of HART Communication Foundation, Austin, USA

PROFIBUS®

Registered trademark of the PROFIBUS User Organization, Karlsruhe, Germany

FOUNDATION™ Fieldbus

Registered trademark of the Fieldbus FOUNDATION, Austin, USA

MODBUS®

Registered trademark of the MODBUS Organization

HistoROM™, S-DAT®, T-DAT™, F-CHIP®, Fieldcheck®, FieldCare®, Applicator®

Registered or registration-pending trademarks of Endress+Hauser Flowtec AG, Reinach, CH

Instruments International

Endress+Hauser
Instruments International AG
Kaegenstrasse 2
4153 Reinach
Switzerland

Tel.+41 61 715 81 00
Fax+41 61 715 25 00
www.endress.com
info@ii.endress.com

Endress+Hauser 
People for Process Automation